

How to measure your kitchen...

KUNALKITCHENS

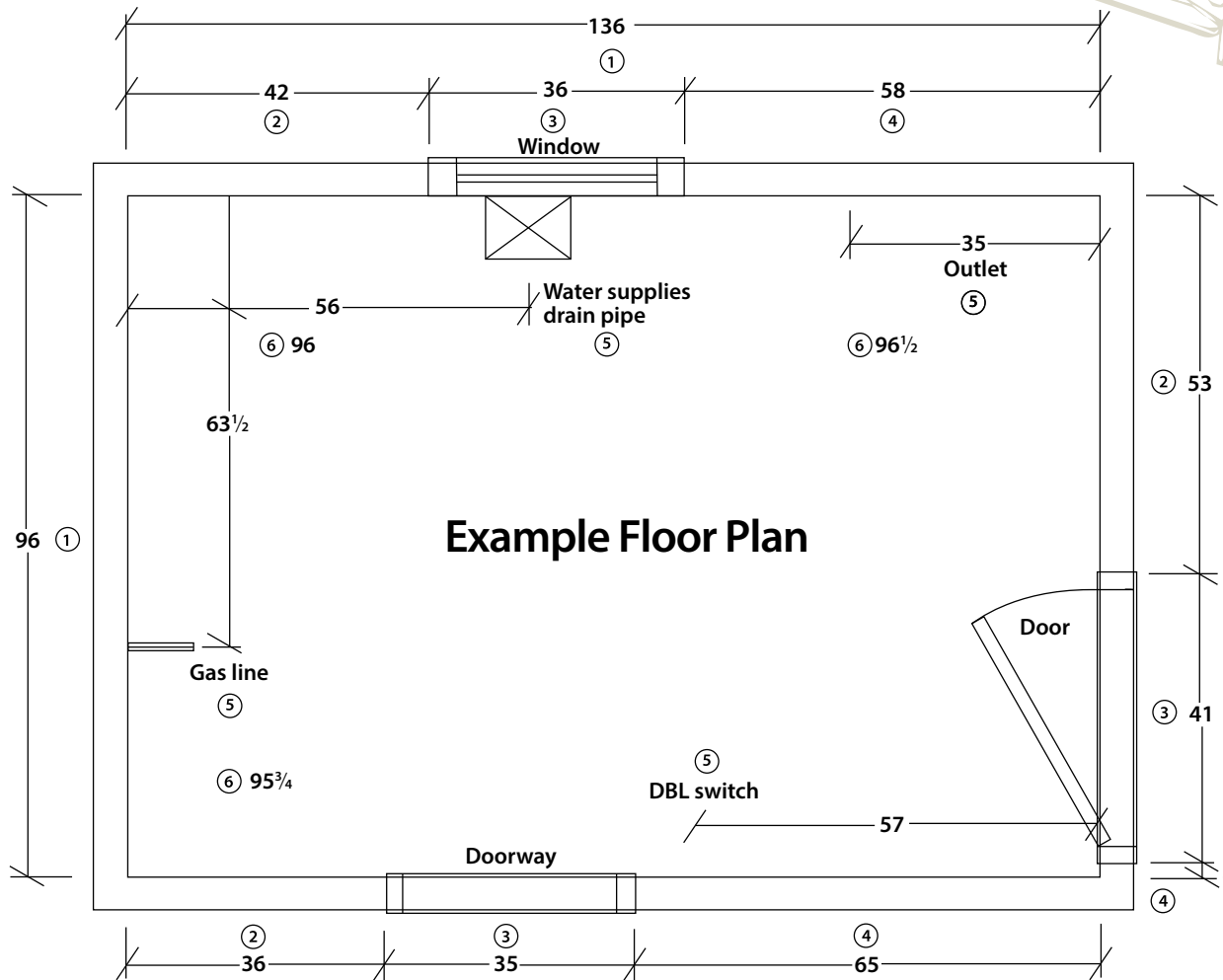

Using a tape measure and paper, measure as outlined below (drawing does not need to be drawn to scale; only measurements need to be correct).

- 1) Measure from wall to wall at 36" height.
- 2) Measure from corner to window or door trim.
- 3) Measure across the window or door opening from trim edge to trim edge (indicate window overall height and height from flooring).
- 4) Measure from edge of trim to far wall (Compare sum of #2, #3 and #4 measurements to step #1).
- 5) Mark exact location of water supplies, drain, gas line and electrical outlets and switches on drawing.
- 6) Measure from floor to ceiling in three areas of kitchen where cabinets will be placed.

Your completed floor plan should resemble the diagram shown.

Take several photos of your existing kitchen to bring with you.



KUNALKITCHENS

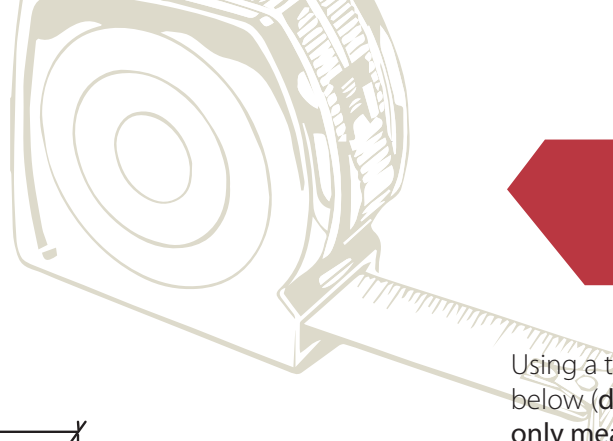

How to measure countertops...

Using a tape measure and paper, measure as outlined below (drawing does not need to be drawn to scale; only measurements need to be correct)

Sketch out the basic shape of your countertops, include all related pieces.

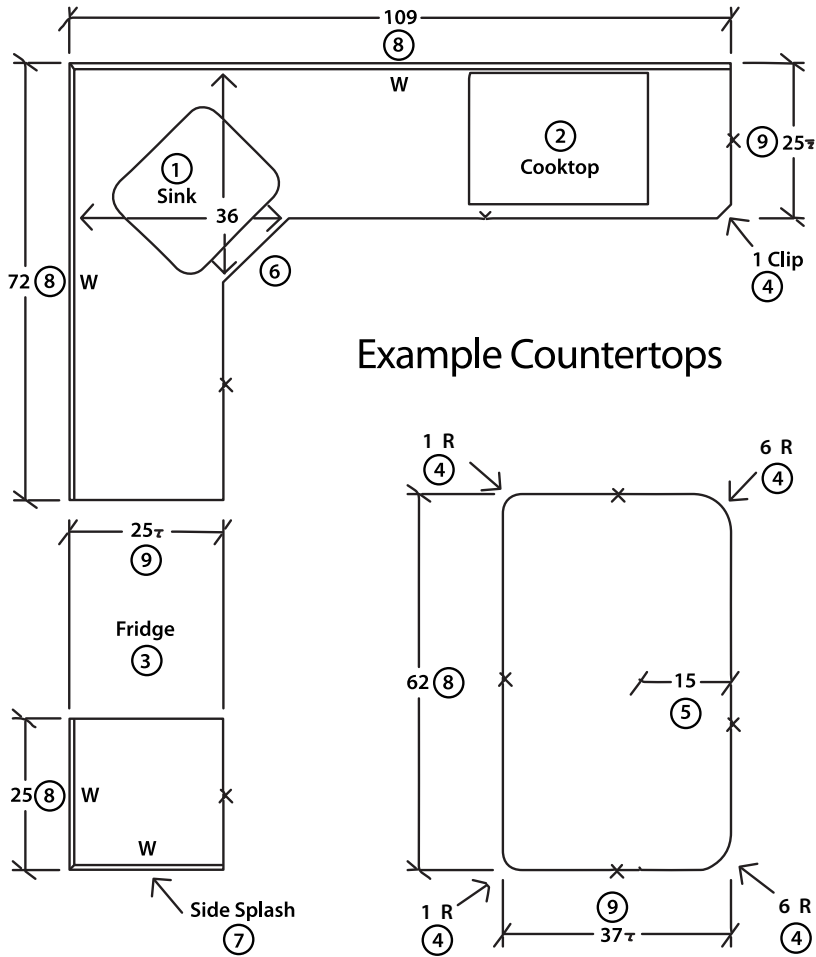

- 1) Mark the sink location and indicate the type of sink (single or double bowl).
- 2) Mark the range location and indicate the type of range (cooktop, free standing or slide-in). If it is a slide-in, does it have a small piece of countertop behind it? Yes No
- 3) Indicate any area on the drawing that is not countertop, such as a pantry, refrigerator, etc.
- 4) Indicate radius corners or clipcorners (measure clip corners across the face of the clip).
- 5) Indicate countertop overhangs for seating, these will need "full build-up" on laminate countertops.
- 6) Indicate a diagonal corner or splay corner and show the dimension as indicated in the example.
- 7) Indicate where walls are ("W") and if any back splash or side splashes with a double line (=====).
- 8) Measure the length of the countertop along the wall from one edge to the opposite edge.
- 9) Measure the depth of the countertop from the back wall (including the back splash) to the finished front edge. Indicate finished edges with an "X".

Your completed sketch should resemble the diagram shown. Take several photos of your existing kitchen to bring with you.